

deli

USER MANUAL

Barcode Scanner No.14952WB

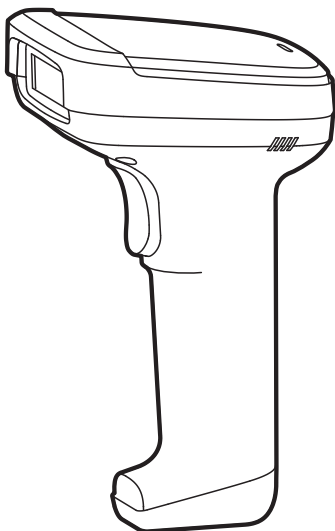

Dear customers , thank you for your products . We are committed to providing our customers with high quality products To ensure best performance,please read this manual carefully before use !

How to use barcode scanner correctly

- 1.If the barcode is small, the barcode shall be close to the product scanning window; On the contrary, if the barcode is large, the barcode should be slightly away from the product scanning window, so that it is easier to read the barcode correctly.
- 2.If the barcode has a high reflectance (for example, the barcode surface is coated with film), the barcode should be kept at a certain angle with the product scanning window, so that the barcode can be successfully scanned.
- 3.When scanning the barcode, it must be aligned and the scanning line must be completely wrapped around the barcode for decoding. It is not allowed to scan only part of the barcode, otherwise there may be error code.

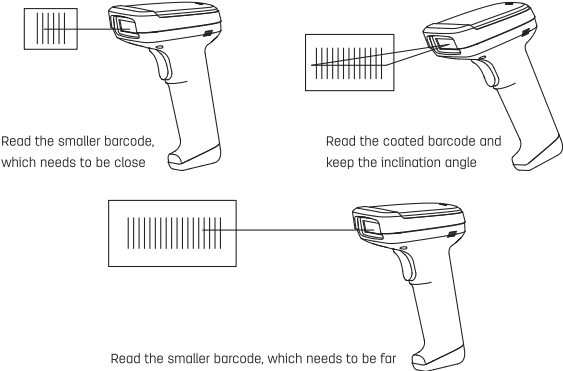

Component description

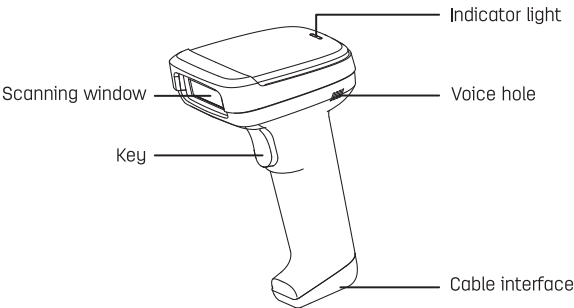

Packing list

Barcode Scanner×1, USB Cable×1, Manual×1, Wireless Receiver×1

Technical parameter

Working voltage	DC 3.7V-4.2V
Operating current	200mA (Typical value)
Maximum peak current	250mA
Standby current	≤ 80mA (Manual reading mode)
Maximum charging current	500mA
Light source	White LED、Red LED
Input voltage	DC 5V±0.25V
Scan barcode category	1D code 2D code
Reading accuracy	1D code ≥ 4 mil 2D code ≥ 7mil
Decoding type	1D code :EAN13, EAN8, UPC-A, UPC-ED, UPC-E1, Code128, Code39, Code93, CodadaBar, Interleaved 2 of 5, Industrial 2 of 5, Matrix 2 of 5, Code11, MSI-Plessey, Standard 2 of 5 Plessey, China Post, Code 16K, GS1 Databar (RSS-Expand, RSS-Limited, RSS-14) 2D code:QR, PDF417, DataMatrix(ECC200), Aztec, Micro QR, Maxicode、Micro PDF417
Operating temperature	0℃ ~ +45℃
Storage temperature	-20℃ ~ +60℃
Operating humidity	5%~90% (No condensated water)
Prompt mode	Buzzer, indicator light
Interface type	USB
Scanning mode	Manual, continuous
The anti-seismic capacity	Can pass the 1.2m free fall test
Transmission Types	2.4G / Bluetooth/ Wired

Product features

1.The built-in storage of this product has the counting function, which can directly carry out some simple daily counting work. All parameter settings of this product can be completed through barcode scanning and saved in the memory of barcode scanner. The inventory content and parameter settings can be retained after the power is turned off.

2.It can directly read one-dimensional barcode and two-dimensional code on mobile phones and computer screens.

- 3.This product has a one button pairing function, (which can easily and quickly complete the transmission).
- 4.In open areas with no electromagnetic interference, the wireless transmission distance is approximately 100 meters for 2.4G and 30 meters for Bluetooth. In typical usage scenarios, the wireless transmission distance is 20-30 meters for 2.4G and 10-20 meters for Bluetooth. When the electromagnetic environment becomes complex and obstacles increase, the transmission distance will decrease. If a longer transmission distance is required, please enable the "Inventory Mode".
- 5.Low power consumption, long standby time, built-in 2000mAh lithium battery.

Receiver installation method

- 1.Plug the wireless receiver into the USB connector of the computer.
- 2.After the wireless receiver is inserted into the computer, the system will automatically install the driver (if the driver installation fails, please unplug the receiver or restart the computer).
- 3.After the driver is installed, the receiver can transmit data with the paired scanner.

Basic settings



Restore Factory Defaults



Add carriage return terminator



Add TAB terminator



Add carriage return line break terminator



Do not add terminators

Reading mode setting



Manual read mode



Automatic continuous reading



Allow to read all barcodes
(all supported barcodes can be read)



Restore the default read barcode settings

Function settings



Normal mode
(instant data upload)



Counting mode
(storage mode)



Data upload



Display the total number of stored items
(the counting mode is applicable)



Clear counting data
(use with caution)

1.Normal mode: scan the barcode into the normal mode, in which the scanning results will be uploaded to the computer in time (this mode is the default mode).

2.Counting mode: scan the barcode to enter the counting mode, in which the scanning results will be stored in the internal memory (when the internal memory is used up, the buzzer will beep three times for prompt)

3.Data upload: scanning the barcode can upload the data stored in the internal memory to the computer in turn (please ensure that the wireless signal is normal when uploading the data in the inventory mode, the buzzer will beep once if the data upload is successful, and the buzzer will beep three times if the data upload fails)

- 4.Display the total number of stored data:** scanning the barcode will display the number of all stored data (the counting mode is applicable).
- 5.Clear counting data:** scanning the barcode will clear all internal memory data.

Match receiver settings

1. Matching Settings for 2.4G Wireless Receiver
Unplug the receiver from the computer and first scan the "2.4G Wireless Mode Code".



2.4G Wireless Mode Code

- 2.4G Wireless Mode Code
Next, scan the "Re-match Receiver" setup code. At this point, the LED indicator will display a green light that is flashing, and scanning of codes is not possible.



Re-matching the Receiver

- Scan the "Re-matching the Receiver" setting code,after the green light flickers continuously, insert the receiver into the computer.The receiver is paired successfully when the beep sound is heard.

2. Wireless Bluetooth Matching Settings
The default Bluetooth name of this scanner is "14952WB HID". First, scan the "Bluetooth HID Wireless Mode Code", and then scan the "Bluetooth Matching Setup Code".



Bluetooth HID wireless mode code

- After the LED blue indicator light starts displaying continuous rapid flashing, within one minute, open the Bluetooth search on the device that needs to be connected. Click to connect to the "14952WB HID" scanner. After hearing a "beep" sound, the Bluetooth pairing connection is successful. This scanner can only connect to one Bluetooth device at the same time.



Bluetooth Matching Setup Code

- Note:
When using on a customer's mobile phone, it is recommended to turn off the physical keyboard and predictive text functions.

3. Bluetooth Mode Data Transmission Speed Settings
The default data transmission speed in Bluetooth mode for the scanner is "Normal Transmission".



Normal Transmission



Low-speed Transmission

Note: Due to differences in connected devices, Bluetooth transmission speeds include "Normal Transmission" and "Low-speed Transmission" to ensure accurate data upload.

Decode sound settings



Turn off decoding sound



Turn on decoding sound

Indicator Description

Indicator Light	Explain
Green Light On	In wired mode/2.4G mode, the green indicator light will briefly flash upon successfully scanning a barcode.
Green Light Slowly Flashing	The green light slowly flashing for 1 minute indicates that the device is currently in 2.4G mode but has not been matched with a receiver
Green Light Rapidly Flashing	The green light rapidly flashing for 1 minute indicates that the 2.4G wireless signal is in the process of being matched
Blue Light On	In Bluetooth mode, the blue indicator light will briefly flash upon successfully scanning a barcode.
Blue Light Slowly Flashing	The blue light slowly flashing for 1 minute indicates that the device is currently in Bluetooth mode but has not been matched with the corresponding terminal.
Blue Light Rapidly Flashing	The blue light rapidly flashing for 1 minute indicates that the Bluetooth wireless signal is in the process of being matched.
Red Light On	The red light remaining constantly on indicates that the device is charging. The red light turning off indicates that the device is fully charged or is not connected for charging.

Sound description

Honking mode	Explain
A long sound	Indicates that the power is on
A short sound	It indicates that the normal barcode is read, or the pairing is successful, or the wireless connection is successful
Three short sounds	It indicates that the normal barcode is read, or the pairing is successful, or the wireless connection is successful
Five short sounds and stop scanning	Indicates that the battery is low (please charge it in time)
Two long sounds	Indicates a wireless disconnection

Power display



Display remaining power

Troubleshooting

NO.	Problem	Possible causes	Solution
1	No power on or power off immediately after power on	Mainly caused by low battery power	Please charge in time to ensure sufficient power (the red light is on when charging, and off when fully charged)
2	Barcode data is not uploaded	Scanner and receiver not paired successfully	Please ensure whether the wireless barcode scanner and receiver are paired (if not, please pair again)
		The distance between the barcode scanner and the receiver is too far	Please check whether the wireless barcode scanner has a signal data upload. (If the buzzer "beeps" three times in a row, it indicates that the signal is insufficient.) The scanner needs to be close to the receiver or switched to the inventory mode
3	There is a Laser line, but the barcode cannot be read	This type of bar code system is not enabled	Open the code system by reading the setting code
		Bar code is damaged	Please try scanning other barcodes with the same barcode type
		Improper distance between scanner and barcode	Please move the barcode scanner near or far away from the barcode
		The height of the barcode scanner is not enough to completely cover the barcode	Read the barcode after aligning it
4	The scanned data is displayed incorrectly on the host	Input method error	Convert the input method to the standard English input method
		Other settings have been made to the scanner	Restore the scanner parameters to the factory settings, or contact the manufacturer's service center
5	The barcode characters are garbled or wrong	The keyboard country setting of the barcode scanner does not match the country where the keyboard is used	Set the barcode scanner keyboard country to match the country where the keyboard is used
6	Other conditions cannot be decoded	Device transfer error	Turn off the power supply of the equipment, connect the equipment and the scanner correctly, turn on the power supply of the equipment, restore the parameters of the scanning platform to the factory settings and scan the code again

Simple maintenance method

1.The dirt and dust on the scanning window sometimes affect the work of the scanner. When cleaning, you should use high-quality facial tissue paper, gently wipe it, and then blow it with a blowing balloon. If the paper with poor quality is used for wiping for a long time, the surface finish of the scanning window will be damaged and the reading effect of the scanner will be affected.

2.The shell of the scanner can be wiped with a soft cleaning cloth. If necessary, a small amount of detergent can be added with water, and then wiped with a soft cloth dipped in water.

Maintenance

Our company is responsible for free maintenance in case of product failure within one year of normal use from the date of purchase.

The start date of the warranty period is subject to the purchase date and invoice of the product warranty card

Please show the product warranty card and invoice during maintenance.

Please keep this warranty card properly. If it is lost, it will not be replaced. The purchase date filled in must be consistent with the invoice number, otherwise it will be invalid.

This card cannot be altered, otherwise it will be invalid. For products beyond the warranty period or not subject to free maintenance, the maintenance service center of our company is still enthusiastic to serve you.

One of the following conditions does not belong to the scope of free maintenance:

- 1.products beyond the warranty period
2. Those who cannot provide purchase invoices or valid vouchers.
3. The appearance is naturally old due to use, and the consumer requires updating.
4. Failure caused by failure to use according to the instructions
5. Failure caused by falling or collision.
6. Failure caused by self assembly, disassembly and repair.
7. Samples and processed products for commercial display and products with performance overload test

The table of toxic and hazardous substances/elements and their content

Part name	Hazardous and noxious substance or elements					
	Pb	Hg	Cd	Cr(VI)	PBB	PBDE
Cable	○	○	○	○	○	○
Electronic parts	×	○	○	○	○	○
Injection molded parts	○	○	○	○	○	○

○: Indicates that this toxic or hazardous substance contained in all of the homogeneous materials for this part is below the limit requirement in SJ/T 11363-2006 «Requirements for Concentration Limits for Certain Hazardous Substances in Electronic Information Products».

×: Indicates that this toxic or hazardous substance contained in at least one of the homogeneous materials used for this part is above the limit requirement in SJ/T 11363-2006 «Requirements for Concentration Limits for Certain Hazardous Substances in Electronic Information Products». Due to limitations of science and technology development, these toxic or hazardous substances cannot be replaced or reduced for now. Under normal use conditions, no leakage or abrupt change will occur within 10 years, nor will it cause pollution to the environment or damage to people and property.

Environment-Friendly Use Period:

This mark refers to the environment-friendly use period of electronic and electrical products sold in accordance with the Regulation of the People's Republic of China on Limit on Use of Hazardous Substances in Electric and Electronic Products and General Guidelines of Environment-friendly Use Period of Electronic Information Products.

WARRANTY CARD

Customer Name		Phone		Postcode	
Mailing Address					
Product Name		Model			
Date of Purchase					
Province		City/town			

REPAIR FORM

Date	Description	Replaced parts		Maintenance Technician
		Name	Quantity	

★ For any question, please contact your local dealer.

CERTIFICATE

Inspector: _____

Date of manufacture: _____

DELI GROUP CO., LTD.

301 Xuxiake Ave. Ninghai County
Ningbo 315600 China Made in China
info@nbdeli.com www.deliworld.com



**KEEP FOR
FUTURE USE**

Version: 1.0
Date: 11-2024